

SCJ Series

Micro Cross Joint Coupling



The precision calibration coupling of the cross joint type, which can easily absorb eccentricity and amplitude instrumentally, is a coupling of unique structure combining both oldham and universal joint that inhibit resisting force delicately and absorb intake tolerances, and Sungil manufactures the product by simple design in such a way that it increases resonance frequency through high rigidity and low inertia and enhances stoppage extent and responsiveness of precision position deciding instrument.

Features

- Regular direction and reverse direction are identical, and uniform revolution is available.
- Has excellent durability and resistance against chemical and oil
- Bearing built in the hub and pin in the center block easily absorb large eccentricity and amplitude.
- Pin and bearing are assembled in high level to minimize backlash.
- Minimize the generation of resisting force with high torsion rigidity and low inertia.
- Deliver control unit angle swiftly in high level.
- Various sizes are available.

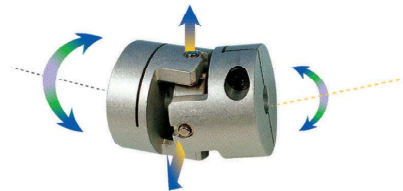

Application

- Robot, X-Y Table
- Semiconductor related instruments and laser processor
- NC, MC machine tool and precision measuring instrument
- NC woodworking machinery, medical equipment and OA machine
- Optical instrument, measuring instrument and aspheric grinder

Structure & Material

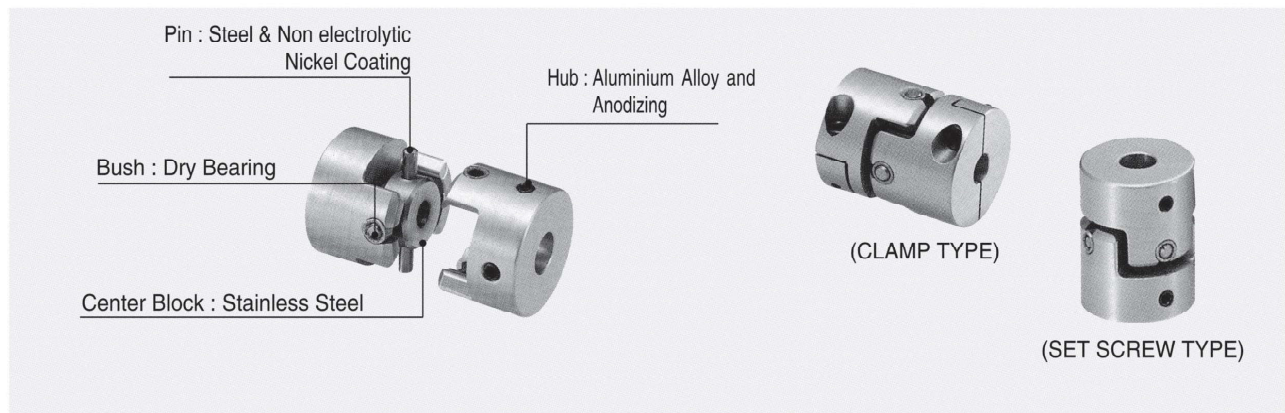

How to order product

SCJ - 20	$\phi 6$	\times	$\phi 8$
Product No.	Shaft Dia		Shaft Dia

※ Please, specify the diameters of both shaft ends in the order form.

SCJ Series Micro Cross Joint Coupling

※ Please, download CAD DATA on www.sungilifa.com

 **SCJ-■ ■ (SET SCREW TYPE)**

 **SCJA-■ ■ C (CLAMP TYPE)**

 **SCJB-■ ■ C (CLAMP TYPE)**

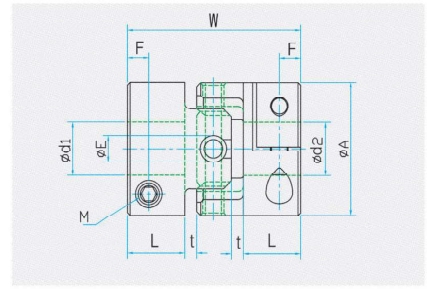
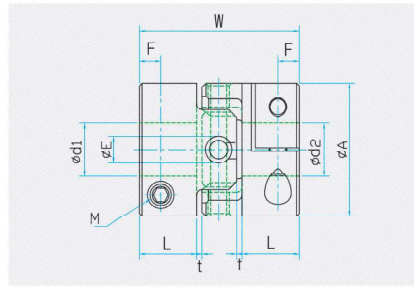
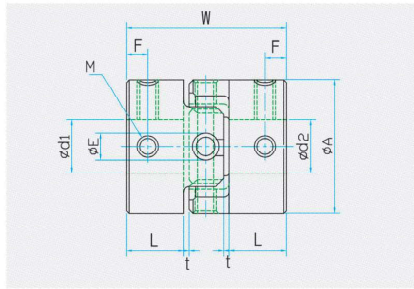

Performance

Product Number	Rated Torque (N·m)	Max Torque (N·m)	Max·RPM (min ⁻¹)	Moment of inertia (kg·m ²)	Torsional Stiffness (N·m/rad)	Parallel (mm)	Angle (°)	mass (g)
SCJA-12C	0.15	0.3	6,000	1.0 × 10 ⁻⁷	110	0.3	3	4.5
SCJA-15C	0.25	0.5	6,000	3.3 × 10 ⁻⁷	220	0.3	3	9
SCJA-20C	0.5	1	6,000	1.2 × 10 ⁻⁶	350	0.5	3	19
SCJA-25C	1	2	6,000	3.3 × 10 ⁻⁶	800	0.5	3	34
SCJA-32C	2	4	5,000	1.1 × 10 ⁻⁵	1,000	0.5	3	72
SCJA-40C	5	10	4,000	3.2 × 10 ⁻⁵	1,400	0.5	3	140
SCJB-12C	0.15	0.3	6,000	1.0 × 10 ⁻⁷	100	0.3	7	4.5
SCJB-15C	0.25	0.5	6,000	3.5 × 10 ⁻⁷	200	0.3	7	10
SCJB-20C	0.5	1	5,000	1.3 × 10 ⁻⁶	300	0.5	7	20
SCJB-25C	1	2	5,000	3.4 × 10 ⁻⁶	700	0.5	7	35
SCJB-32C	2	4	4,500	1.2 × 10 ⁻⁵	950	0.5	7	75
SCJB-40C	5	10	3,500	3.3 × 10 ⁻⁵	1,200	0.5	7	145
SCJ-12	0.15	0.3	6,000	1.0 × 10 ⁻⁷	100	0.3	3	4.5
SCJ-15	0.25	0.5	6,000	3.3 × 10 ⁻⁷	200	0.3	3	9
SCJ-20	0.5	1	6,000	1.3 × 10 ⁻⁶	450	0.5	3	20
SCJ-25	1	2	6,000	3.4 × 10 ⁻⁶	800	0.5	3	35
SCJ-32	2	4	5,000	1.2 × 10 ⁻⁵	1,000	0.5	3	75
SCJ-40	5	10	4,000	3.3 × 10 ⁻⁵	1,300	0.5	3	145

Standards & Standard Inner diameter

Product Number	A	L	W	t	E	F	M	(d ₁ , d ₂) Standard INNER Diameter (mm)											
								3	4	5	6	6.35	8	10	11	12	14	15	
SCJA-12C	12.7	7.2	20.2	0.7	2	2.4	2	●	●	●									
SCJA-15C	15	8	22.4	0.8	2.5	3	2.6	●	●	●	●								
SCJA-20C	20	8	23.6	0.8	4	3	2.6		●	●	●	●							
SCJA-25C	25	10.5	30.6	1.3	5	3.6	3			●	●	●	●						
SCJA-32C	32	13.5	39	1.6	8	4.5	4				●	●	●	●	●	●	●	●	●
SCJA-40C	40	16	45.6	1.9	10	6	5					●	●	●	●	●	●	●	●
SCJB-12C	12.7	7.2	22.1	1.5	2	2.4	2	●	●	●									
SCJB-15C	15	8	24.2	1.8	2.5	3	2.6	●	●	●	●	●							
SCJB-20C	20	8	26.5	2.2	4	3	2.6		●	●	●	●	●						
SCJB-25C	25	10.5	33.5	2.8	5	3.6	3			●	●	●	●						
SCJB-32C	32	13.5	43	3.6	8	4.5	4				●	●	●	●	●	●	●	●	●
SCJB-40C	40	16	51	4.5	10	6	5					●	●	●	●	●	●	●	●
SCJ-12	12.7	7.2	20.2	0.7	2	2.4	2.5	●	●	●									
SCJ-15	15	8	22.4	0.8	2.5	3.8	3	●	●	●	●	●							
SCJ-20	20	8	23.6	0.8	4	3.8	3		●	●	●	●	●						
SCJ-25	25	10.5	30.6	1.3	5	5	4			●	●	●	●	●					
SCJ-32	32	13.5	39	1.6	8	6.5	5				●	●	●	●	●	●	●	●	●
SCJ-40	40	16	45.6	1.9	10	8	5					●	●	●	●	●	●	●	●

INNER diameter INCH type is also available.
 KEY TYPE is also available
 Non standard inner diameter product is also available